

# **4** ***Pay-Per-View***

## **ORDER AND WATCH PAY-PER-VIEWS**

---

Is tonight a popcorn and movie night? Why rent videos when you can just watch Pay-Per-Views? This chapter describes how to use these additional services:

- **BUYING A PAY-PER-VIEW PROGRAM**
- **REVIEWING PAY-PER-VIEW PURCHASES**

## User Guide

To buy Pay-Per-View programs, you must connect the receiver to an active phone line. After you buy a Pay-Per-View program, you can watch it on all of the receivers on your Bell TV account. Using the remote control, you can order the exact same program for each receiver but you pay for the program only once. However, replays of programs are separate events.

## BUYING A PAY-PER-VIEW PROGRAM

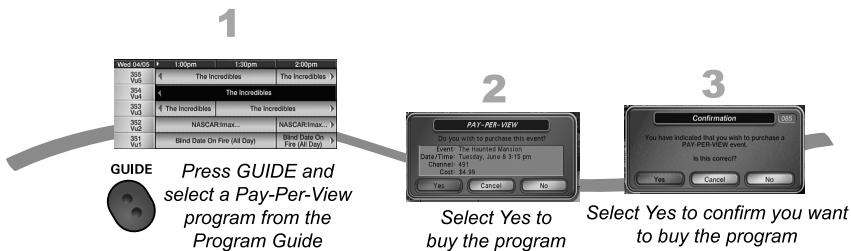

**Note:** Once you confirm an order for a Pay-Per-View program, you cannot cancel the order and you will be billed for it.

## REVIEWING PAY-PER-VIEW PURCHASES

Use this feature to review events you've purchased, including those you have watched and those you purchased but have not yet watched.

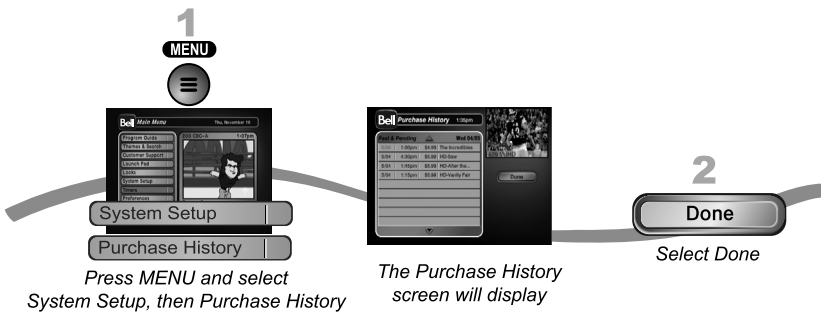

## TIPS

---

- You can prevent others from purchasing Pay-Per-View programs by using locks (see page 6-6).

## QUESTIONS

---

- **How can I order an event for all my receivers?**
  - Order on each receiver, one at a time with the remote control. Make sure an active phone line is connected to each receiver.
  - Order the event over the phone 1-866-68ORDER.
- **Will I be charged more than once for ordering the same Pay-Per-View on two or more receivers?** You won't be charged more than once as long as it is the same exact event (for example, at the same time or All Day events).
- **Why doesn't my Program Guide show any Pay-Per-View channels?** You may be using a Favourites List that doesn't include Pay-Per-View channels. Press GUIDE to open the Program Guide and then press GUIDE again until you see All Chan in the upper left corner of the Program Guide. See *Chapter 5 - Favourites Lists* on page 5-1 for more information on using Favourites Lists.



# *User Guide*

## **Notes**

